

DITTA	RIF.	DENOMINAZIONE	T-290A
	DATA	CODICE	9.290.609.00
	02/11/09		

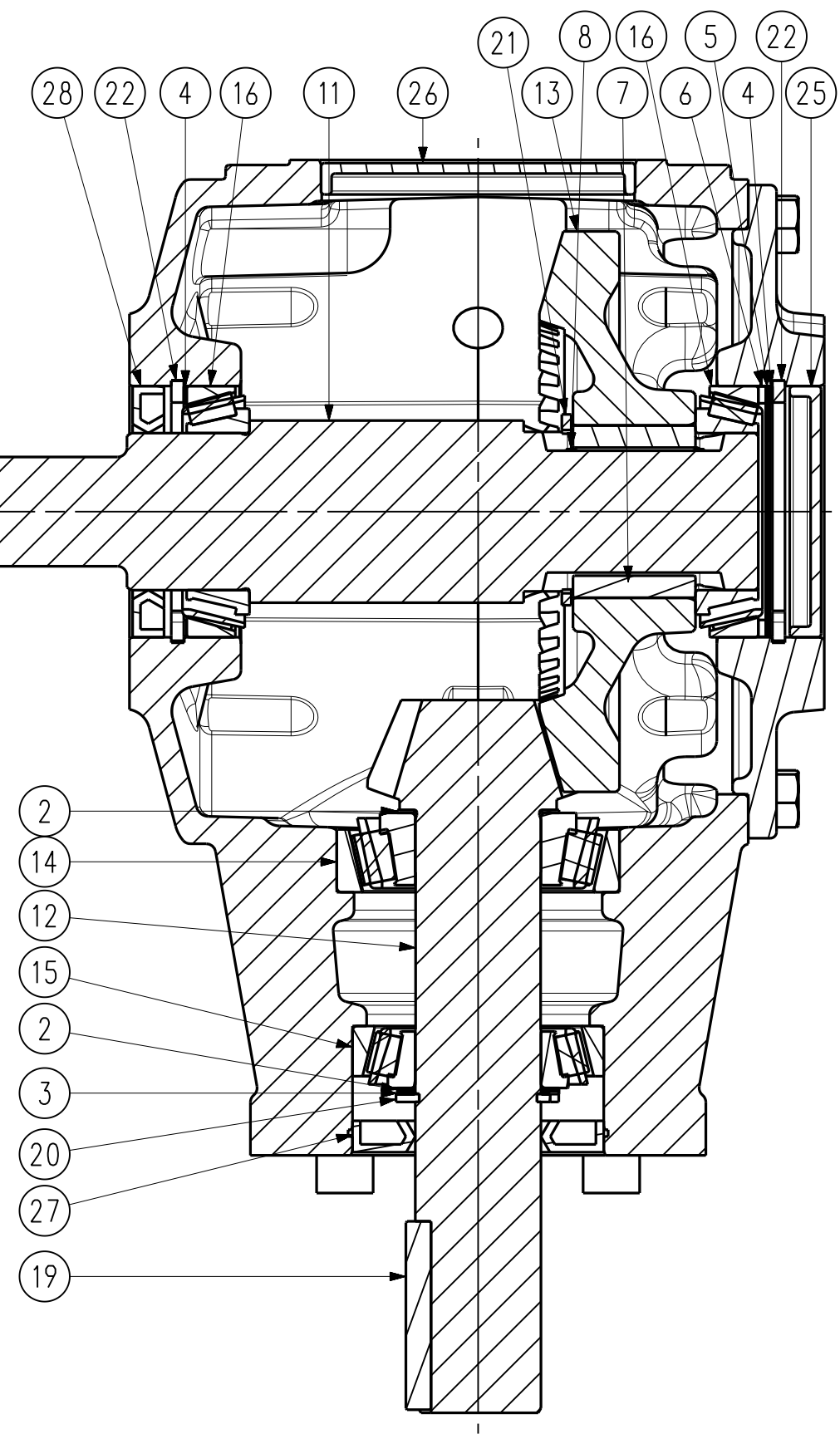

SEZ./SECT. A-A

PC NO	PART NAME	QTY	SAP MATERIAL	DESC
1	0.124.7101.00	1	TARGHETTA "COMER"	
2	0.244.7500.00	2	SPES.REG. 40.3x51.5	
3	0.244.7510.00	1	SPES.REG. 51.5x40.3x1.0	
4	0.267.7500.00	2	SPES.REG. 69.0x79.9	
5	0.267.7510.00	1	SPES.REG. 69.0x79.7x1.0	
6	0.267.7525.00	1	SPES.REG. 69.0x79.7x2.5	
7	0.269.7119.00	2	LINGUETTA x R.L.	
8	0.269.7120.00	2	MOLLA A LAMINA x R.L.	
9	0.290.0309.00	1	SCATOLA A.P. vel.	
10	0.290.1367.00	1	COPERCHIO	
11	0.290.3214.00	1	ALBERO CALETTATO 1"3/8 Z6 R.L.	
12	0.290.5003.00	1	ALBERO PIGNONE CON. Z12 M5	
13	0.290.6006.00	1	CORONA CONICA R.L. Z36 M5	
14	8.0.9.00128	1	CUSC.RULLI CON.CLB 30308	
15	8.0.9.01060	1	CUSC.RULLI CON.CLA 30208	
16	8.0.9.01241	2	CUSC.RULLI CON.CLB 32010 X	
17	8.1.1.00061	8	VITE TE M10x25 UNI5739 8.8	
18	8.1.2.00311	4	VITE TCEI M12x30 UNI5931 8.8	
19	8.4.1.01834	1	LINGUETTA TEMPRATA A 12x8x60	
20	8.5.1.00680	1	ANELLO EL.SIC. x ALB 40 H=2,5 UNI7436	
21	8.5.1.00928	1	ANELLO EL.SIC. x ALB 55 H=3 UNI7436	
22	8.5.2.01370	2	ANELLO EL.SIC. x FORO 80 H=4 UNI7438	
23	8.6.5.00006	4	TAPPO CON.ESAG.EST. 3/8"Gas	
24	8.6.7.00161	1	TAPPO SFIATO ANTICOND. 3/8"Gas	
25	8.7.0.00790	1	CAPPELLOTTO DI CHI. 80x10	
26	8.7.0.00975	1	CAPPELLOTTO DI CHI. 100x10	
27	8.7.3.00027	1	AN.TEN.NORM. BA 40x80x10	
28	8.7.3.00958	1	AN.TEN.NORM. BA 50x80x10	

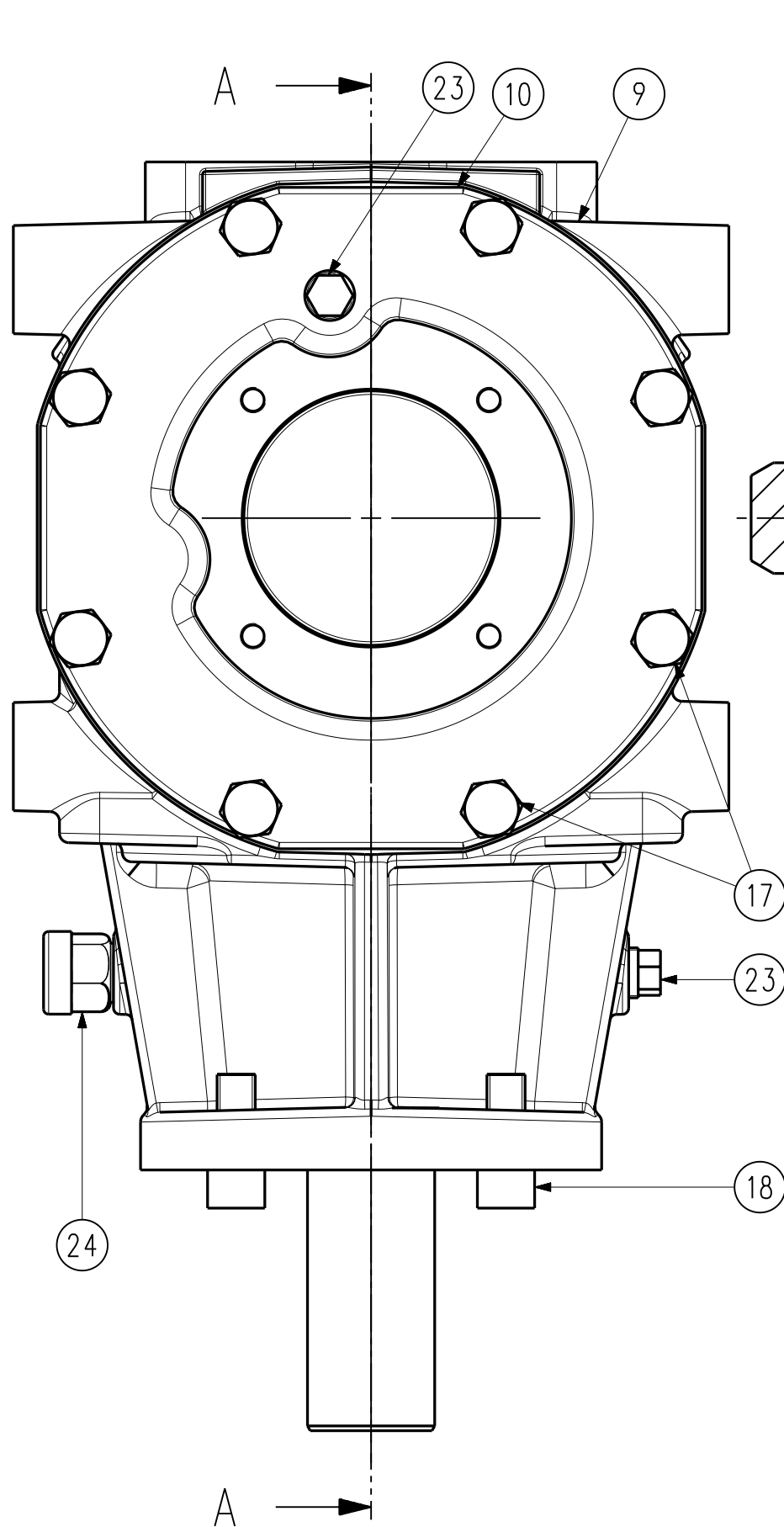